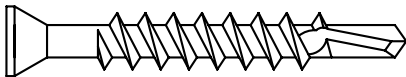
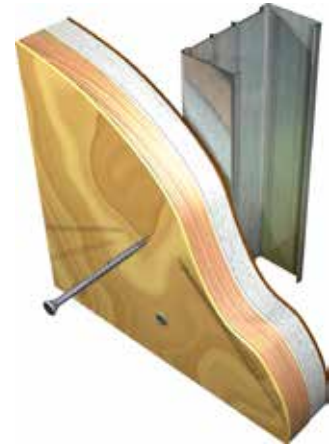

Heavy Gauge Metal (20ga or thicker)**Product #242****Trim Head DRIVALL® Self Drilling** (1 OF 2)**Attaches wood trim over single or double layer gypsum board to 20-12 ga. steel.****Finish - Black/Gray Phosphate**Trim
Head

Drill Point

#1 Square
Drive**APPLICATIONS**

- ▶ Wood trim over single and double layer gypsum board to 20-12 gauge steel studs and track

PRODUCT FEATURES

- ▶ Self tapping drill point is designed for penetration into 20-12 gauge steel
- ▶ #1 Phillips recess or #1 square drive
- ▶ Trim head leaves a finished surface

SPECIFICATIONS

- ▶ Gauge – #7 and #8
- ▶ Lengths – 1-5/8" to 3"
- ▶ Head Type – Trim
- ▶ Recess Type - #1 Square
- ▶ Thread Type – Single Lead
- ▶ Finish – Gray Phosphate, Clear Zinc
- ▶ GRABBER® screws are manufactured in an ISO 9001 and ISO 14001 certified and approved factory.

INSTALLATION GUIDELINES

- ▶ Use a standard screwgun with a depth-sensitive nose piece. Suggested screwgun specification for optimal performance – 4 amps minimum and RPM range of 0 to 2,500.
- ▶ The Trim head is fully seated when the head is flush with the work surface.
- ▶ Overdriving may result in failure of the fastener or stripout of the work surface.
- ▶ The fastener must penetrate beyond the metal a minimum of three thread pitches.

Heavy Gauge Metal (20ga or thicker)

Product #242

Trim Head DRIVALL® Self Drilling (2 OF 2)

PRODUCT SIZES AND ORDERING INFORMATION

Catalog No.	Gauge/Length	Length Metric	Quantity Per Carton	Weight Per Carton
17SD	#7x1-5/8"	41 mm	5 M	28.00(lbs)
18SD	#7x2-1/4"	57 mm	4 M	29.00(lbs)
17SD76	#8x3"	76 mm	2 M	22.00(lbs)

PRODUCT DIMENSIONS (MILLIMETERS)

Gauge	B Head Dia	Recess Depth	W Gauging Width	d Shank Dia	d1 Minor Dia	d2 Major Dia	TPI
#7	5.30	1.50	#1	3.03	2.45	3.75	19
	5.80	2.08		3.07	2.65	3.95	
#8	5.30	1.50	#1	3.28	2.85	4.05	18
	5.80	2.08		3.32	3.05	4.25	

PULL-OUT TEST DATA

Screw Gauge	Metal Gauge	Tension (lbs.)	Shear (lbs.)
#7	14	708	1479
	16	454	1148
	18	361	1140
	20	213	777
#8	14	450	1012
	16	442	955
	18	340	1045
	20	265	680

**GRABBER fasteners are not categorized as structural bolts. The figures listed above are ultimate average values achieved under independent laboratory conditions, and apply to GRABBER Line fasteners only. An appropriate safety factor must be determined by a qualified professional for design purposes.

STANDARD CORROSION TEST RESULTS

Finish	Test	Standard/Protocol	Results
Black/Gray Phosphate	Salt Spray Results	ASTM B117	24 hours, no red rust

SHEET STEEL GAUGES

Gauge No.	Decimal Equivalent	Millimeter Equivalent
14	0.0713"	1.8 mm
16	0.0566"	1.5 mm
18	0.0451"	1.2 mm
20	0.0396"	1 mm

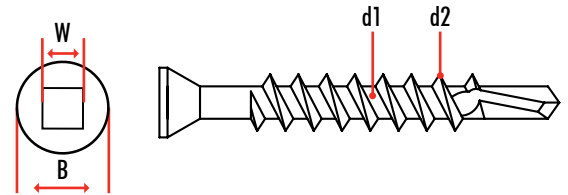

DRILLING CAPACITY

Screw Gauge	Drill Point	Max Panel Thickness	Steel Thickness Gauge Range
6	3	0.090-0.110	20-12
8	3	0.100-0.140	20-12

All GRABBER® screw products are manufactured in facilities that are ISO 9001 certified. ©2012 GRABBER Construction Products, Inc. GRABBER®, STREAKER®, DRIVALL®, LOX®, GRABBERGARD® and SCAVENGER® are registered trademarks of Grabber Construction Products, Inc.

